



iOS - Connecting to the Staff Wifi

This guide will walk you through connecting an iOS device such as an iPhone or iPad to the staff wireless network.

Written By: Wayne Peterson

Connect to
Wireless on
iOS

Step 1 — iOS - Connecting to the Staff Wifi

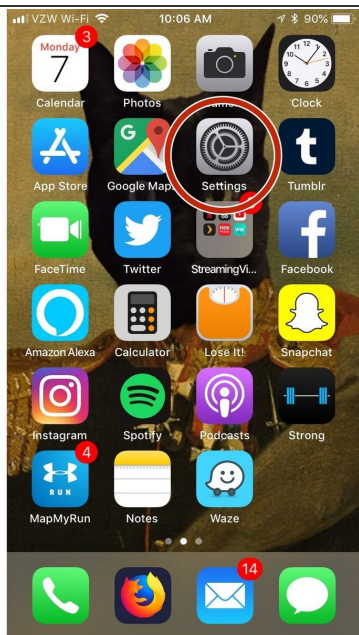

- From the Home Screen, select **Settings**.

Step 2

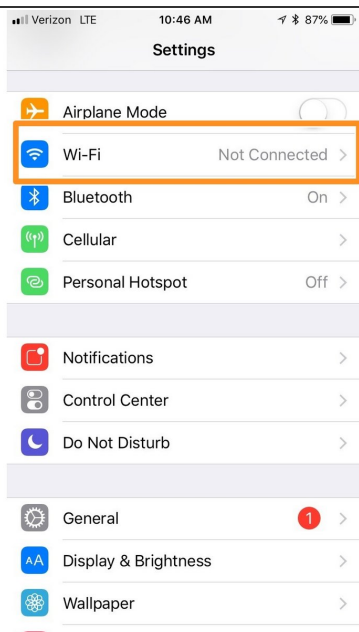

- From the Settings menu, select **Wi-Fi**.

Step 3

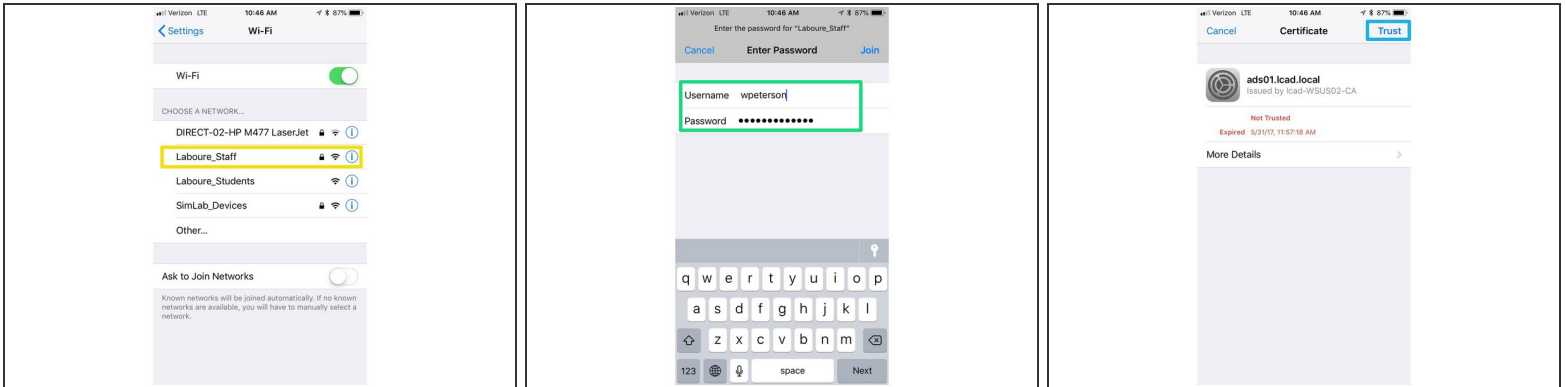

- From the Wi-Fi menu, select **Laboure_Staff**
- Enter your username and password in the fields provided and tap **Join**.
- Tap **Trust** in the top-right.

Step 4

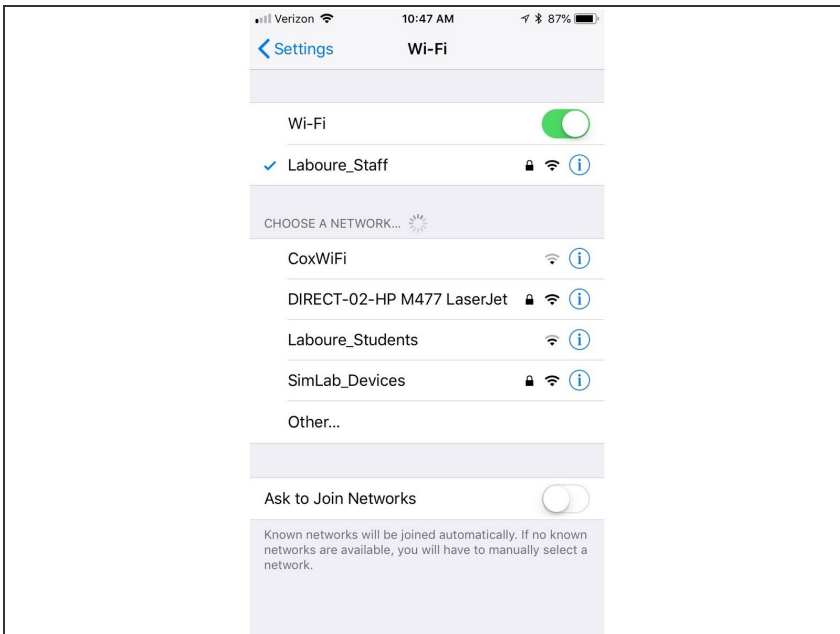

- You are now connected to the **Laboure_Staff** network.