



# Access Your Labouré Grammarly Account

How to access your licensed Labouré Grammarly account.

Written By: Edward Akers

Access Your  
Grammarly  
Account

## Step 1 — Grammarly.com

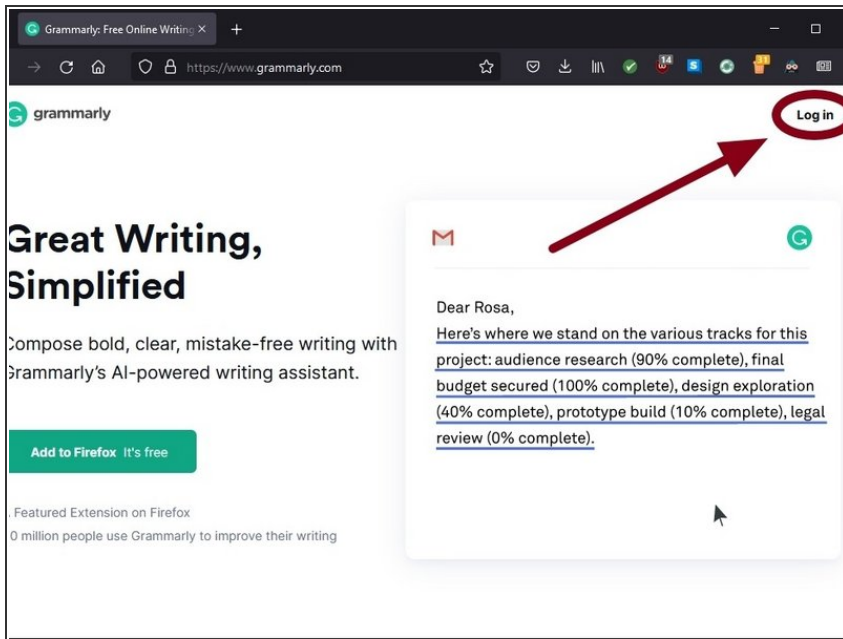

- In your web browser of choice, navigate to [Grammarly.com](https://www.grammarly.com)
- In the top right corner of the page, click **Log in**

## Step 2 — Sign In

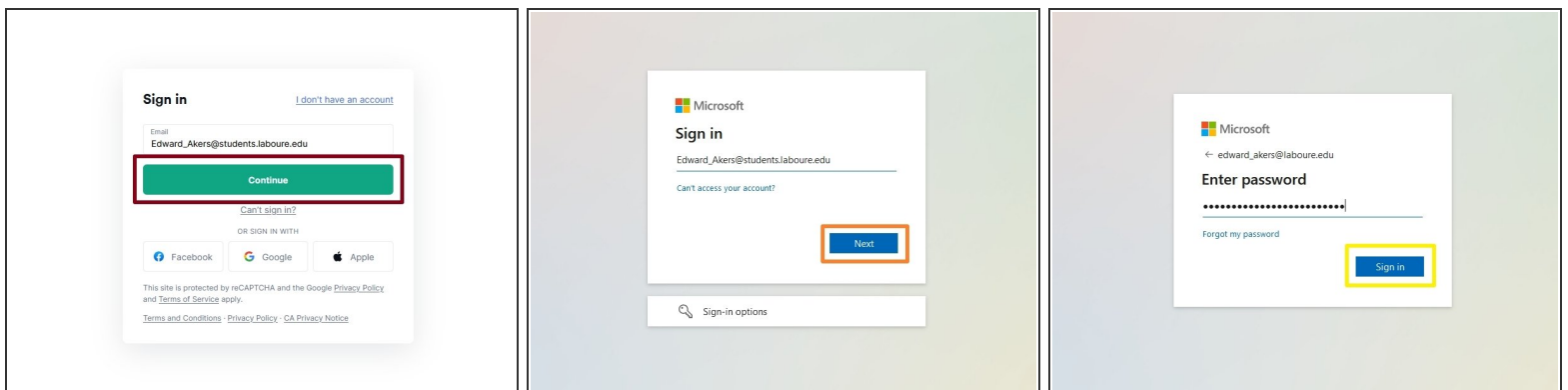

- Enter your Labouré student email address and click **Continue**
- On the Microsoft sign-in page, enter your student email again and click **Next**
- Enter your student email password and click **Sign in**

## Step 3 — Signed In

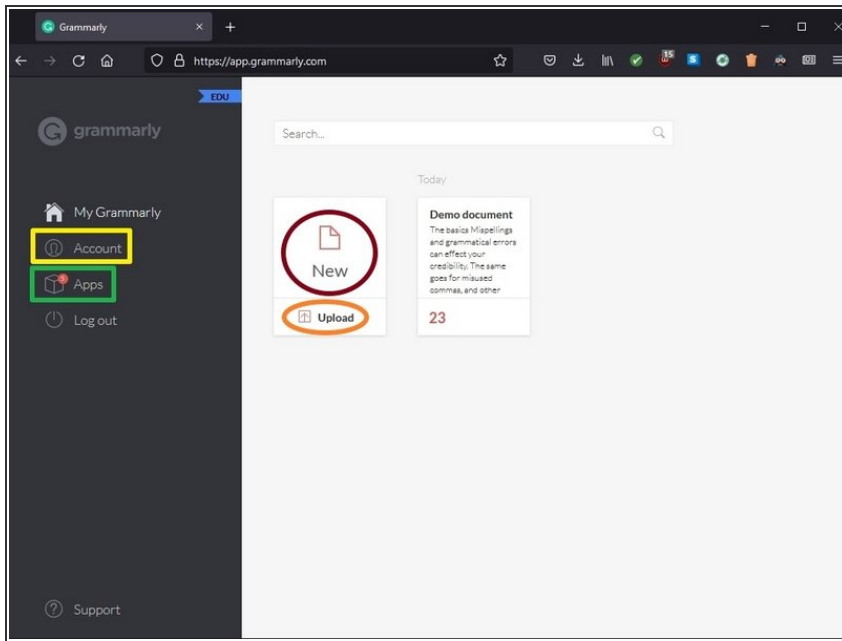

- Once successfully signed in, you will be taken to the My Grammarly dashboard. From here you can:
  - Begin writing a new document (**New**)
  - Upload an existing document for editing (**Upload**)
  - Manage your account settings (**Account**)
  - Download Grammarly for desktop, browsers, and Microsoft Office as well as the Grammarly smartphone keyboard (**Apps**)